



THE GREEN TEAM

Idling Reduction Signs and Materials Application

THE GREEN TEAM
 320 Riverside Drive 1-A
 Northampton, MA 01062
 (413) 586-7350 ext. 225 Phone
 (413) 586-7351 Fax

E-mail: recycle@thegreenteam.org

www.thegreenteam.org

Please complete the form, have it signed by your principal and submit it by mail or fax. The requested materials will be shipped directly to your school at the address you specify below. (Delivery cannot be made to a P.O. Box). Please print clearly or type.

Name of Receiver _____ Title _____

School Name _____

Address _____ City/Town _____ Zip _____

Telephone _____ Fax _____

E-mail Address: _____



A



B

Idling Reduction Signs

These signs are designed for posting in school driveways and parking lots to remind bus drivers and parents not to idle unnecessarily. All signs are 0.08 gauge aluminum, engineering grade reflective sheeting, 18" high by 12" wide with two holes for mounting on a post, wall or fence. Post not included.

(A) Idle-Free Zone Sign – Lettering is white on a blue background with a red “no” symbol.

Quantity: _____

(B) No Idling Sign – Lettering is black on a white background with a red “no” symbol.

Quantity: _____

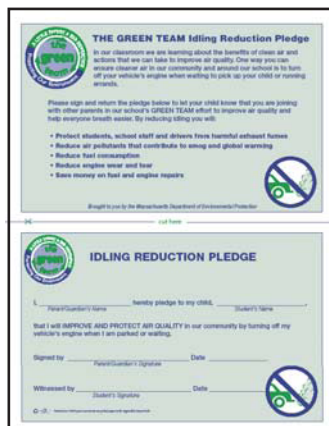

Idling Reduction Pledge Cards

Packaged in sets of 50, pledge cards are available for classes participating in the Idling Reduction Pledge Activity. Printed on recycled paper.

Quantity: _____
 (In multiples of 50)



THE GREEN TEAM Idling Reduction Signs and Materials Application



Static Sticker Windshield Decals

These 3" x 3" decals can be distributed to drivers and affixed to the windshield as a reminder not to idle. The decal should be placed in the lower left corner of the windshield so as not to obscure visibility. The decal adheres without adhesives and is removable. Consider providing these to students who return signed Idling Reduction Pledges.

Quantity: _____
(In multiples of 50)



Bumper Stickers

For display on cars, buses and municipal vehicles. Consider providing these to students who return signed Idling Reduction Pledges. 3"x12".

Quantity: _____
(In multiples of 50)



School Bus Dashboard Stickers

This 4"x 8" removable sticker can be displayed on a school bus driver's dashboard to remind the driver and educate students about clean air initiatives.

Quantity: _____
(In multiples of 50)

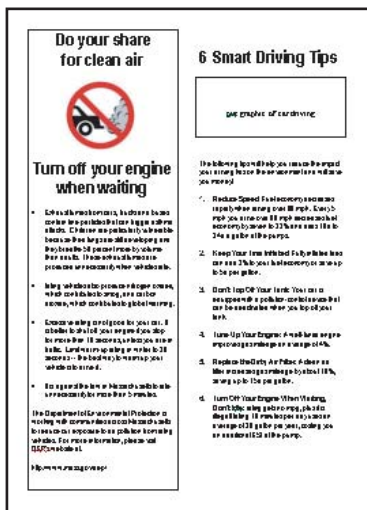

Palm Cards

These informational cards can be distributed in classes and at public events at school and in the community. 3.5" x 8.5".

Quantity: _____
(In multiples of 100)



THE GREEN TEAM Idling Reduction Signs and Materials Application

Please answer the following questions:

1. Is your school a member of The Green Team? Yes____ No____
2. Is this a new Idling Reduction program for your school? Yes____ No____
3. Is there a specific date that you need the materials by? _____
4. Please describe how you intend to use the requested materials: _____

Signature of Principal _____

Signature of Applicant _____ **Applicant's Title/Position** _____

Submit application form by mail or fax to:

THE GREEN TEAM
320 Riverside Drive 1-A
Northampton, MA 01062
(413) 586-7351 Fax

THE GREEN TEAM is sponsored by:



The Massachusetts Executive
Office of Environmental Affairs
and Department of Environmental Protection